

SHEET NO. 1  
 PLAN NO. 1681  
 FOR  
**MOUNTAIN VIEW AVENUE SEWER**  
 FROM  
 CLUSTER ST. TO MILL ST.  
 CITY OF SAN BERNARDINO  
 CALIFORNIA

JAN. 1947  
 PLAN ADOPTED March 31, 1947.

EDGAR  
 CITY  
 APR  
 1947

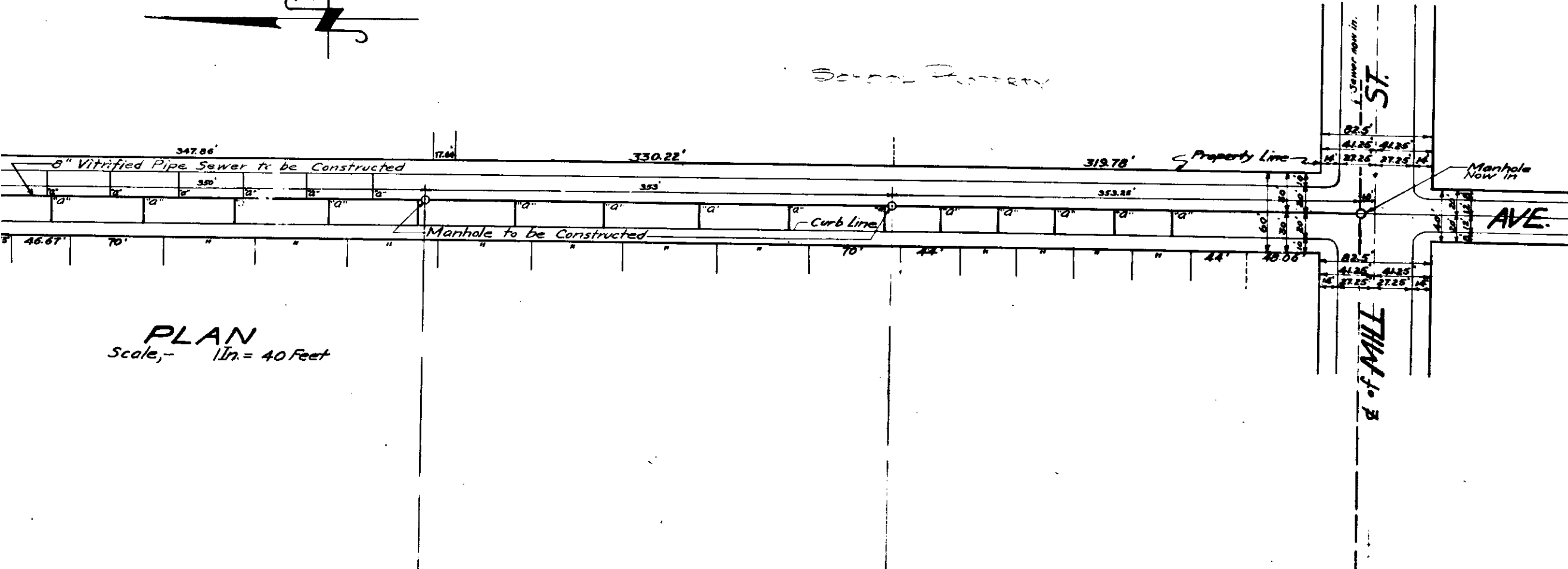
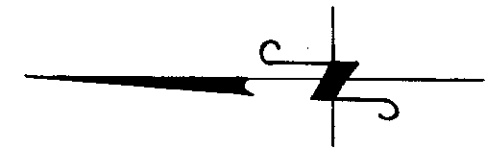

**PLAN**  
 Scale, - 1 in. = 40 Feet

**LEGEND**  
 " or ft. means inch or feet.  
 N# means Number.  
 C.L. means Center Line.  
 El. means Elevation.  
 8" Vitrified Pipe Sewer to be constructed, shown thus: ———  
 8" x 4" Wyes with 4" connecting Sewers, to be constructed shown thus: ———  
 Manholes to be constructed shown thus: ———  
 8" Vitrified Pipe Sewer now in shown thus: - - - - -  
 Manholes now in shown thus: - - - - -

**SEWER DETAIL**  
 Lineal Ft. of 8" vitrified pipe sewer to be constructed. ———  
 Lineal Ft. of 4" vitrified pipe sewer to be constructed. - - - - -  
 N# of 8" x 4" wyes with 4" connecting sewers to be constructed. - - - - -  
 N# of Manholes to be constructed. - - - - -

**TITLE TO STREETS**  
 MOUNTAIN VIEW AVENUE, dedicated by Map of the  
 M. INTOSH'S LITTLE FARMS, recorded in Book 23 of Maps,  
 at Page 53, Records of San Bernardino County, California.

**GRADE RESOLUTION**  
 GRADE OF MOUNTAIN VIEW AVENUE established by Ordinance  
 NR1964 of the City of San Bernardino, California adopted August 18, 1947

**DATUM**  
 All Elevations shown in Red ink are in feet and  
 on a plane which is 1045.28 feet below the City Bench  
 established by Ordinance 383 of the City of San Bern  
 California.

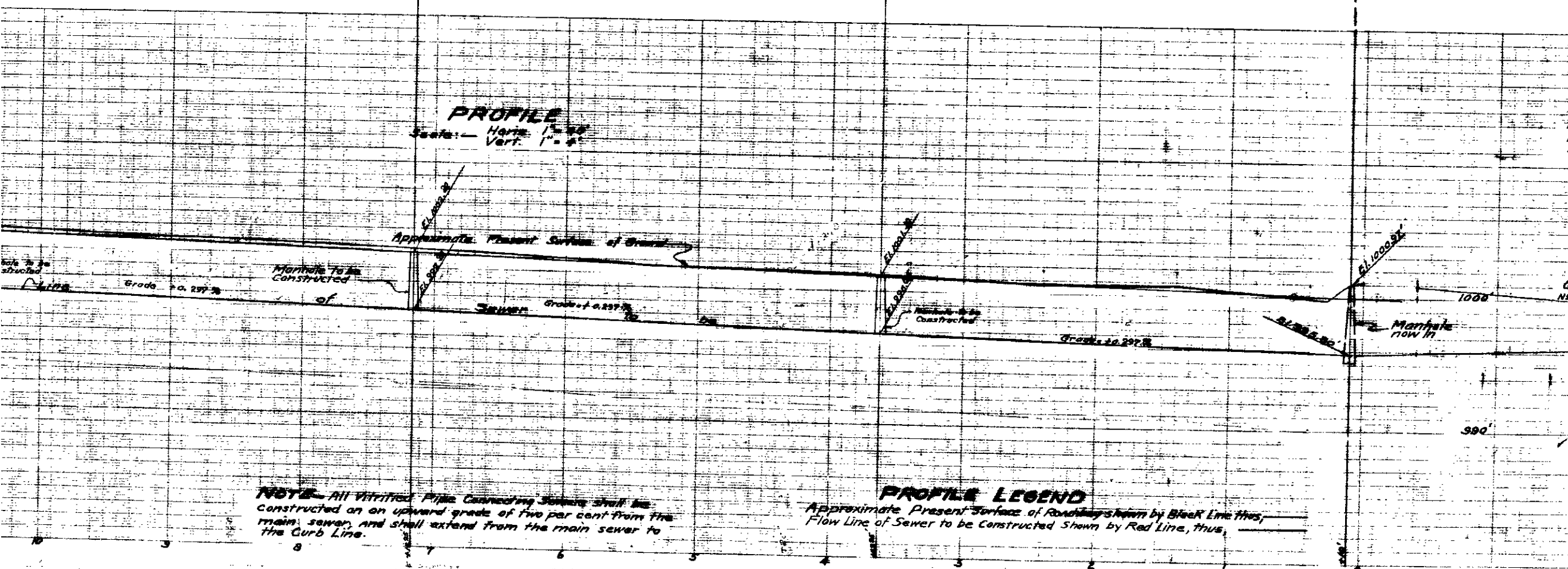

**PROFILE**  
 Scale: - Horiz. 1" = 40'  
 Vert. 1" = 4'

**PROFILE LEGEND**  
 Approximate Present Surface of Roadway shown by Black Line, thus: ———  
 Flow Line of Sewer to be Constructed Shown by Red Line, thus: ———

**NOTE** - All Vitrified Pipe Connecting Sewers shall be  
 constructed on an upward grade of two per cent from the  
 main sewer, and shall extend from the main sewer to  
 the Curb Line.

SHEET NO. 1  
 PLAN NO. 1681  
 FOR  
**MOUNTAIN VIEW AVENUE SEWER**  
 FROM  
 CLUSTER ST. TO MILL ST.  
 CITY OF SAN BERNARDINO  
 CALIFORNIA

JAN. 1947  
 PLAN ADOPTED March 31, 1947.

EDGAR  
 CITY  
 APR  
 1947

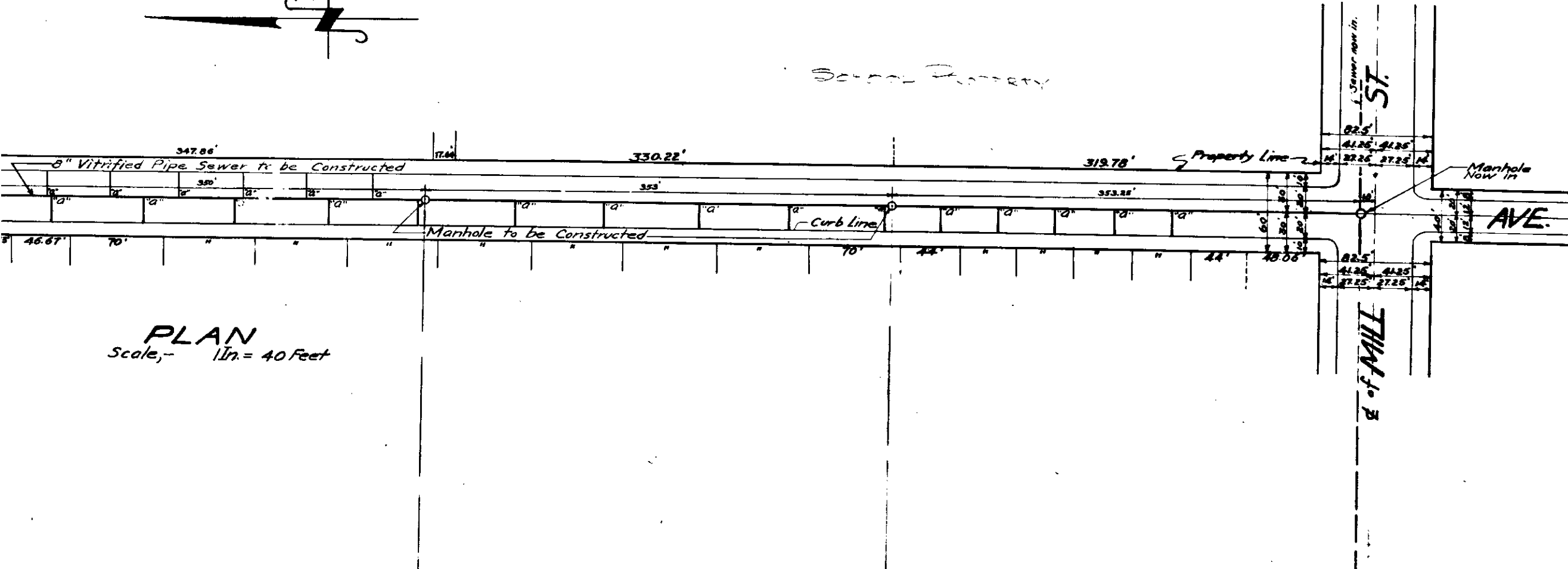
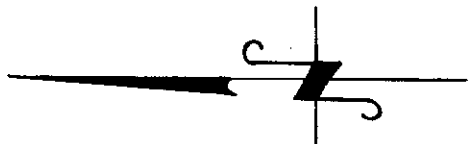

**PLAN**  
 Scale, - 1 in. = 40 Feet

**LEGEND**  
 " or ft. means inch or feet.  
 N# means Number.  
 C.L. means Center Line.  
 El. means Elevation.  
 8" Vitrified Pipe Sewer to be constructed, shown thus  
 8" x 4" Wyes with 4" connecting Sewers, to be constructed shown thus  
 Manholes to be constructed shown thus  
 8" Vitrified Pipe Sewer now in shown thus  
 Manholes now in shown thus  
 St. means Street  
 Ave. means Avenue  
 Blvd. means Boulevard  
 Calif. means California

**SEWER DETAIL**  
 Lineal Ft. of 8" vitrified pipe sewer to be constructed  
 Lineal Ft. of 4" vitrified pipe sewer to be constructed  
 N# of 8" x 4" wyes with 4" connecting sewers to be constructed  
 N# of Manholes to be constructed

**TITLE TO STREETS**  
 MOUNTAIN VIEW AVENUE, dedicated by Map of the  
 M. INTOSH'S LITTLE FARMS, recorded in Book 23 of Maps,  
 at Page 53, Records of San Bernardino County, California.

**GRADE RESOLUTION**  
 GRADE OF MOUNTAIN VIEW AVENUE established by Ordinance  
 NR1964 of the City of San Bernardino, California adopted August 18, 1947

**DATUM**  
 All Elevations shown in Red Ink are in feet and  
 on a plane which is 1045.28 feet below the City Bench  
 established by Ordinance 383 of the City of San Bern  
 California.

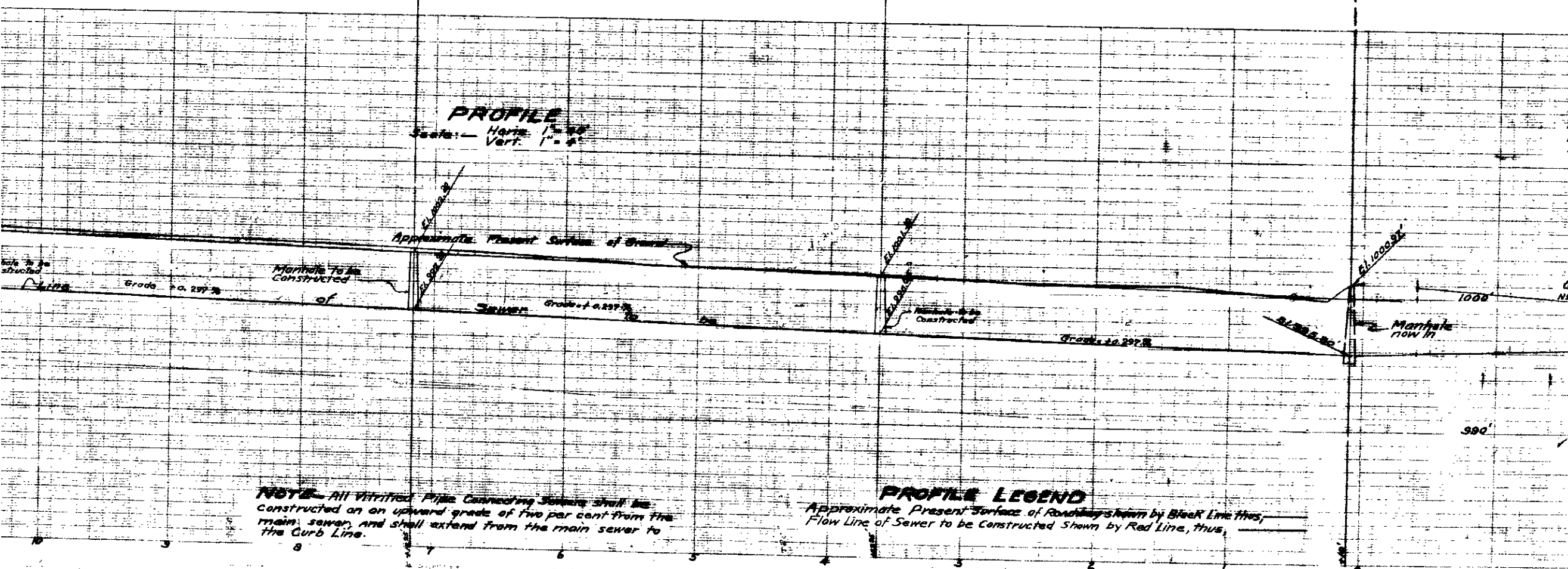

**PROFILE**  
 Scale: - Horiz. 1" = 40'  
 Vert. 1" = 4'

**PROFILE LEGEND**  
 Approximate Present Surface of Roadway shown by Black Line, thus  
 Flow Line of Sewer to be Constructed Shown by Red Line, thus

**NOTE** - All Vitrified Pipe Connecting Sewers shall be  
 constructed on an upward grade of two per cent from the  
 main sewer, and shall extend from the main sewer to  
 the Curb Line.